

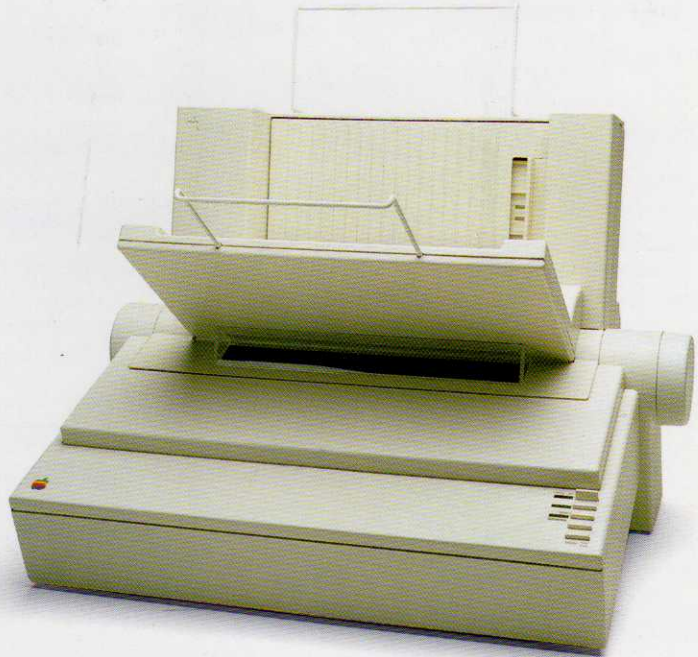

ImageWriter™ II SheetFeeder Installation Manual



ImageWriter™ II SheetFeeder Installation Instructions
Chargeur feuille-à-feuille ImageWriter II : Guide d'installation
Inbetriebnahme-Anleitung für den ImageWriter II Einzelblatteinzug
ImageWriter II: Installazione del Caricatore di fogli singoli

Apple® II, II Plus, IIc, IIe, III, Macintosh,™ Macintosh XL/Lisa®

Copyright

©Copyright 1985 Apple Computer, Inc. for all nontextual material, graphics, figures, photographs, and all computer program listings or code in any form, including object and source code. All rights reserved.

Apple, the Apple logo, and ImageWriter are registered trademarks of Apple Computer, Inc.

Printed in Japan.

Droits de Reproduction

©Copyright 1985 Apple Computer, Inc. pour tout document non-rédactionnel, graphiques, figures, photographies, et listes de programmes ou d'instructions sous quelque forme que ce soit, programmes sources et programmes objets inclus. Tous droits réservés.

Apple, le logo Apple et ImageWriter sont des marques déposées d'Apple Computer, Inc.

Imprimé au Japon.

Zur Beachtung

©Copyright 1985 Apple Computer, Inc. für das gesamte Material, außer Text, einschließlich Grafiken, Abbildungen und Fotos sowie für alle Computer-Programme als Ausdruck oder Code in jeder Form einschließlich Quell- und Objekt-Code. Alle Rechte vorbehalten.

Der Name Apple, das Apple-Zeichen und ImageWriter sind eingetragene Warenzeichen von Apple Computer, Inc.

Gedruckt in Japan.

Licenza di Copyright

©Copyright 1985 Apple Computer, Inc. su tutto il materiale grafico, figure, fotografie e tutti i listati di programmi per computer o codici in qualsiasi forma, inclusi i codici oggetto e sorgente. Tutti i diritti riservati.

Apple, il logo Apple e ImageWriter sono marchi registrati della Apple Computer, Inc.

Stampato in Giappone.



ImageWriter™ II SheetFeeder
Installation Instructions

Chargeur feuille-à-feuille ImageWriter II :
Guide d'installation

Inbetriebnahme-Anleitung für den
ImageWriter II Einzelblatteinzug

ImageWriter II: Installazione del
Caricatore di fogli singoli

Contents

ImageWriter II SheetFeeder Installation Instructions	1
Unpacking the SheetFeeder	2
Installing Your SheetFeeder	3
Loading Paper	6
Testing the SheetFeeder	8
Loading a Single Sheet of Paper	9
Unloading Paper	10
Leaving the SheetFeeder in Place	10
Removing the SheetFeeder	11
Caring for Your SheetFeeder	11
If Your SheetFeeder Doesn't Work	12

Chargeur feuille-à-feuille ImageWriter II : Guide d'installation	13
Déballage de votre Chargeur feuille-à-feuille	14
Installation de votre Chargeur feuille-à-feuille	15
Chargement du papier	18
Vérification du Chargeur feuille-à-feuille	20
Chargement d'une feuille simple	21
Déchargement du papier	22
Laisser le Chargeur feuille-à-feuille en place	22
Retirer le Chargeur feuille-à-feuille	23
Soin de votre Chargeur feuille-à-feuille	23
Si votre Chargeur feuille-à-feuille ne fonctionne pas	24

Inbetriebnahme-Anleitung für den ImageWriter II Einzelblatteinzug	25
Auspacken	26
Montage des Einzelblatteinzugs	27
Einlegen von Papier	30
Einzelblatteinzug überprüfen	32
Einzug eines einzelnen Blattes	33
Entfernen des Papierstapels	34
Wenn der Einzelblatteinzug installiert bleibt	34
Abbau des Einzelblatteinzugs	35
Pflege und Wartung	35
Fehlerbeseitigung	36

ImageWriter II: Installazione del Caricatore di fogli singoli	37
Apertura dell'imballo del Caricatore di fogli singoli	38
Installazione del Caricatore di fogli singoli	39
Caricamento della carta	42
Prova del Caricatore di fogli singoli	44
Caricamento di un foglio singolo	45
Rimozione della carta	46
Lasciare installato il Caricatore di fogli singoli	46
Rimozione del Caricatore di fogli singoli	47
Manutenzione del Caricatore di fogli singoli	47
Se il Caricatore di fogli singoli non funziona	48

ImageWriter™ II SheetFeeder Installation Instructions

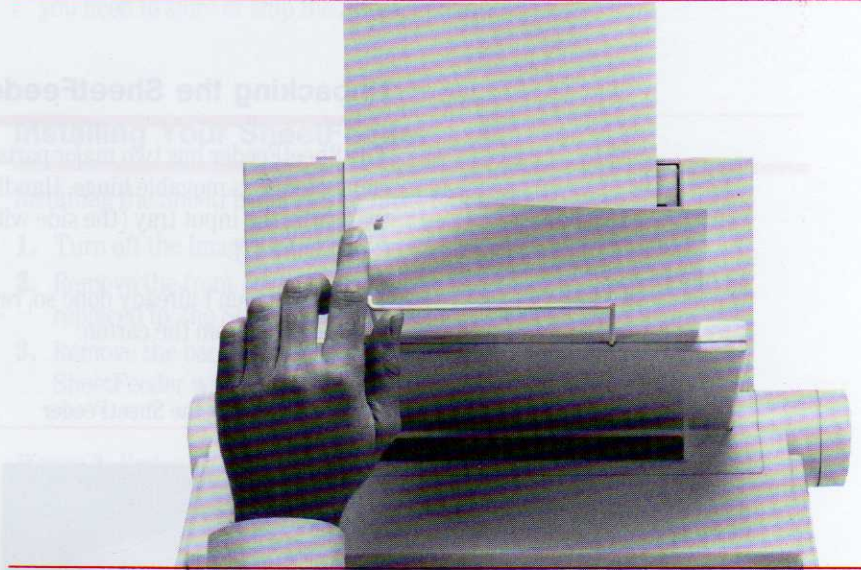

By the Way: If you intend to have the SheetFeeder installed, be sure to have this manual in a safe place.

The ImageWriter™ II SheetFeeder is the most convenient way to use your ImageWriter II to print on stationery and letterhead as well as other standard office paper. This manual explains how to install, use, and care for the SheetFeeder.

Before You Begin

This manual assumes you have read your *ImageWriter II Owner's Manual* and have already unpacked, set up, and tested your ImageWriter II.

Unpacking the SheetFeeder

The SheetFeeder has two major parts, the input tray and the output tray, connected by a movable hinge. Handle the SheetFeeder by the larger of the two parts, the input tray (the side without the clear plastic window). (See Figure 1.)

1. If you haven't already done so, remove the SheetFeeder and all packing materials from the carton.

Figure 1. Holding the SheetFeeder

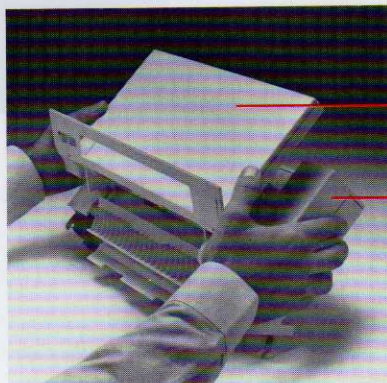

Printed Paper Holder

Blank Paper Loader

